



Guidelines and safety instructions for the stay on the premises of Ecolab Engineering GmbH

Welcome to the Ecolab Engineering GmbH in Siegsdorf. The safety of our visitors and employees is of great importance to us. We therefore ask you to carefully read and observe the following guidelines and safety instructions.

- ▲ Please save the telephone number of your contact person as a contact in your mobile phone. Please also record the department you are visiting.
- ▲ Park in our visitor parking lot.
- ▲ Always go to the main entrance of company building C, please. Please register at the reception, then you will be picked up by your contact person. After your visit, you will be required to check out personally.
- ▲ If you find the door locked, please call your contact person. If your contact person is not available, please dial one of the following telephone numbers in accordance with the department you are visiting:

Food & Beverage	+49(0)86 62 61 205
Industrial Technology Division	+49(0)86 62 61 123
Institutional, Textile Care, Healthcare	+49(0)86 62 61 341
Purchasing department	+49(0)86 62 61 180
Switchboard	+49(0)86 62 61 0

- ▲ Your contact person will let you into the building and assist you with the visitor registration. Please also have the license plate number of your car ready.
- ▲ We ask for your understanding that we receive our visitors exclusively in building C. Your contact person will accompany you to the arranged place of appointment.
- ▲ Please inform your host about possible allergies to prevent potential incidents.
- ▲ For security reasons, access to the production areas is not possible. We only allow access as part of a guided company tour. A visit to the production area requires a prior arrangement and is carried out exclusively in the company of staff from the Ecolab Engineering GmbH.
- ▲ Please observe the safety instructions on the back page.

- P** Visitor parking lot
- 1** Reception (registration)
- 2** Gathering place

- Production area
- Smoking area

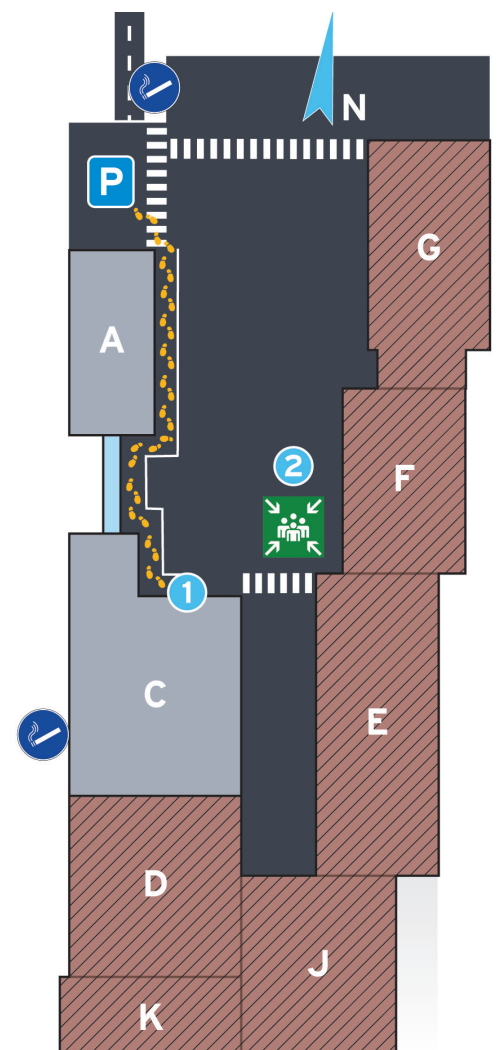

Safety instructions

- ▲ Please keep to the marked visitor paths!
- ▲ In the factory protective goggles, safety vests and safety shoes (or shoes with safety caps) are mandatory.
- ▲ There is an helmet obligation for the high rack storage area.
- ▲ In an emergency, please contact your Ecolab Engineering contact person.
- ▲ Be sure that you know where escape paths and exits are located.
- ▲ In the case of an evacuation, go to the corresponding gathering place (see site plan).
- ▲ Alcohol and smoking are prohibited over the entire company premises. Smoking is permitted only in the designated smoking areas.
- ▲ Photographing and filming is generally not permitted. Information on ongoing research projects, production methods, documents and equipment are not to be disclosed to others.
- ▲ Forklift trucks have priority.
- ▲ The maximum permissible speed on the entire premises is 10 km/h.
- ▲ Further important signs at the site:
First aid, access prohibited, mobile phone banned in production area
- ▲ Please use this QR code or PC terminals for reporting safety deficiencies.

